



HI-STANDARD REVOLVER

WESTERN-STYLE

PARTS PRICE LIST-.22 CALIBER MODEL W-104

"DOUBLE-NINE"

NUMBERS ARE ONLY FOR BLUED GUNS — SEE PARTS LIST FOR NICKEL

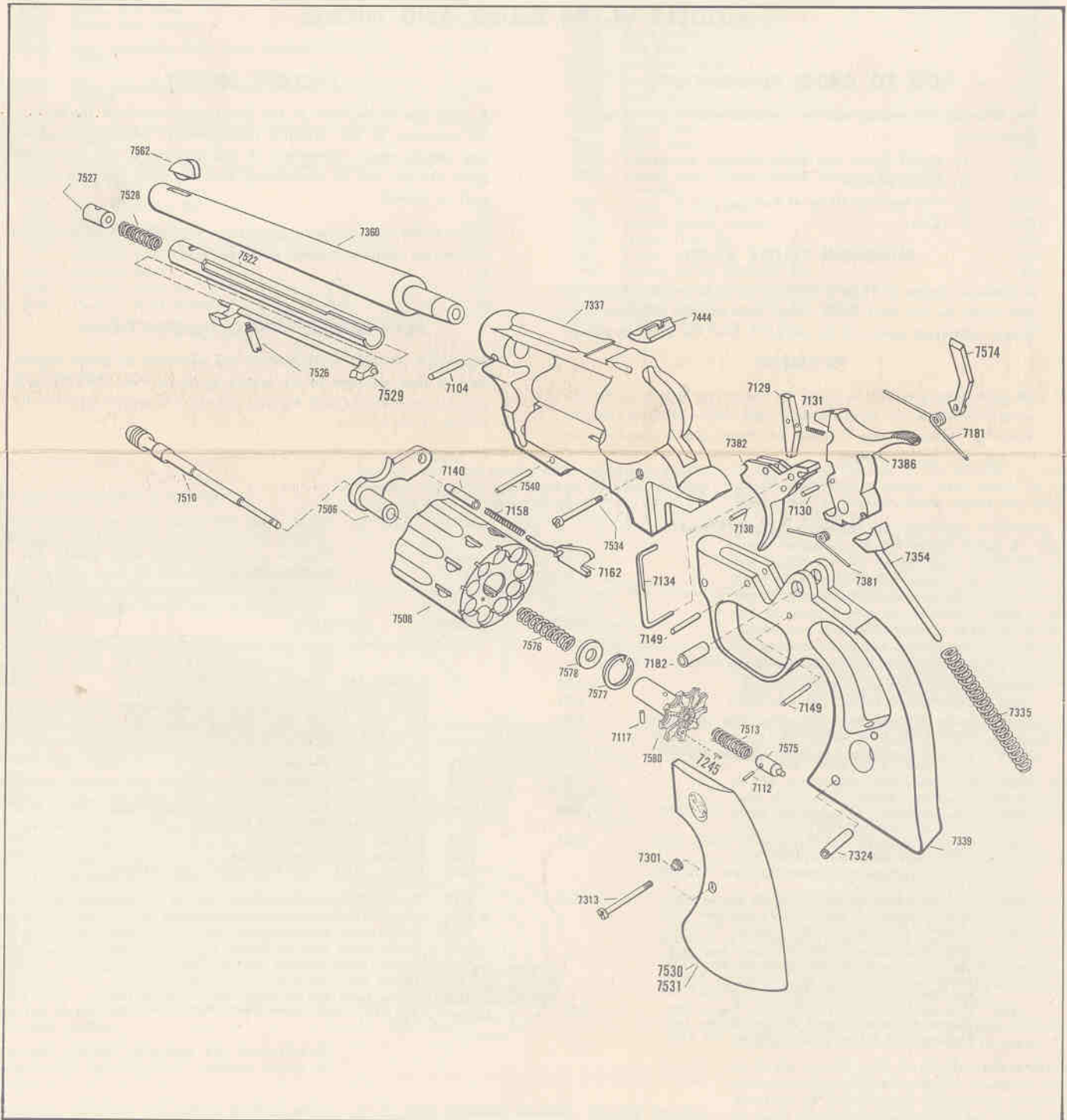

THE HIGH STANDARD MANUFACTURING CORPORATION

HAMDEN • CONNECTICUT

HI-STANDARD

.22 CALIBER DOUBLE- AND SINGLE- ACTION REVOLVER

PARTS LIST AND PRICES

(Prices Subject to Change Without Notice)

"DOUBLE-NINE"

MODELS W-104 BLUED AND NICKEL

HOW TO ORDER REPAIR PARTS

The following information must be furnished when ordering replacement parts:

1. Model Name and Series Number W-104
2. Serial Number
3. Number and Name of Parts
4. Color

MINIMUM ORDER \$1.00

A minimum charge of \$1.00 is made on all orders where the normal cost would be less than \$1.00. Please note also the following paragraph. Additional parts will be added to meet the minimum charge.

PAYMENT

All parts shipments will be made by Parcel Post C.O.D. unless advance remittance is made. PLEASE DO NOT SEND CASH OR STAMPS. Checks, Money Orders, or Drafts are acceptable and will save you C.O.D. charges.

FACTORY SERVICE

If parts are to be fitted at the factory, send revolver marked for the attention of our SERVICE DEPARTMENT, furnishing complete and specific repair instructions. A cost estimate of the parts and labor charges will be immediately sent for your approval before work is started.

Unless a flat rate charge is specified, a MINIMUM of \$6.50 will be charged on servicing revolver at the factory.

REVOLVER SHIPPING INSTRUCTIONS

BONAFIDE DEALERS IN FIREARMS are permitted by postal regulations to send revolvers to the factory by Parcel Post. INDIVIDUALS are not permitted to mail firearms and we recommend shipment by railway express.

All shipments to factory must be prepaid.

MODEL W-104

Part Number	Part Name	Price
Parts Marked With An Asterisk (*) Must Be Fitted at the Factory		
*7360	Barrel (5 1/2") Blue, (Without Sight)	\$ 8.00
*7460	Barrel (5 1/2") Nickel, (Without Sight)	9.00
*7515	Barrel & Front Sight Assembly, Blue (includes Barrel 7360, Front Sight 7562)	8.50
*7494	Barrel & Front Sight Assembly, Nickel (includes Barrel 7460, Front Sight 7562)	9.50
7104	Barrel Pin, Blue	.25
7196	Barrel Pin, Nickel	.40
7506	Crane Assembly, Blue (includes Crane Link 7505, Crane Link Bearing 7107)	3.00
7406	Crane Assembly, Nickel (includes Crane Link 7407, Crane Link Bearing 7107)	3.85
7508	Cylinder, (Not Sold Separately. See Cylinder Assembly)	16.50
7670	Cylinder Assembly, Blue, (Includes Ejector 7580, Ejector Alignment Dowel 7117, Cylinder Lock Plunger 7575, Cylinder Lock Plunger Pin 7112, Cylinder Lock Plunger Spring 7513, Cylinder Ejector Alignment Pin 7245, Ejector Rod 7510, Ejector Return Spring 7576, Retaining Ring 7577, Return Spring Washer 7578, Crane Link Assembly 7506, Cylinder 7508, Cylinder Bushing 7110)	18.50
7423	Cylinder Assembly, Nickel, (Includes Ejector 7580, Ejector Alignment Dowel 7117, Cylinder Lock Plunger 7575, Cylinder Lock Plunger Pin 7112,	

MODEL W-104

Part Number	Part Name	Price
7575	Cylinder Lock Plunger	.65
7112	Cylinder Lock Plunger Pin	.25
7513	Cylinder Lock Plunger Spring	.25
7162	Cylinder Stop Assembly, (includes Cylinder Stop 7114, Cylinder Stop Cross Pin 7115)	1.85
7158	Cylinder Stop Spring	.25
7245	Cylinder Ejector Alignment pin	.25
7580	Ejector, (Not sold Separately. See Cylinder Assembly)	
7117	Ejector Alignment Dowel	.25
* 7581	Ejector Assembly (not sold separately)	1.00
7522	Ejector Latch Housing, Blue	1.00
7422	Ejector Latch Housing, Nickel	2.00
7526	Ejector Latch Housing Screw, Blue	.25
7426	Ejector Latch Housing Screw, Nickel	.30
7529	Ejector Latch Rod Assembly, Blue (includes Latch Rod 7521, Latch Thumb Piece 7525, Latch. Hook 7524)	1.25

CAUTION: FOR SAFETY'S SAKE DO NOT ATTEMPT TO REPAIR REVOLVER WITHOUT RECEIVING RELIABLE

MODEL W-104

MODEL W-104

Part Number	Part Name	Price
7429	Ejector Latch Rod Assembly, Nickel (includes Latch Rod 7521, Latch Thumb Piece 7525, Latch Hook 7524,	2.50
7527	Ejector Latch Housing Plug, Blue	.35
7427	Ejector Latch Housing Plug, Nickel	.40
7528	Ejector Latch Rod Spring	.25
7576	Ejector Rod Return Spring	.25
7301	Escutcheon Nut	.25
*7337	Frame, Blue (Not Sold Separately)	
*7437	Frame, Nickel (Not Sold Separately)	
7510	Ejector Rod, Blue	1.25
7410	Ejector Rod, Nickel	1.50
†7530	Grip Assembly, R.H., Ivory (includes Medallion 10355)	2.00
†7531	Grip Assembly, L.H., Ivory (includes Medallion 10355)	2.00
†7327	Grip Assembly, R.H., Black (includes Medallion 10356)	2.00
†7328	Grip Assembly, L.H., Black (includes Medallion 10356)	2.00
7313	Grip Screw	.25
7324	Grip Alignment Pin	.25
7386	Hammer	4.50
7388	Hammer Assembly, (includes Hammer 7386, Hammer Pawl 7129, Pin 7130, Spring 7131)	5.50
7129	Hammer Pawl	1.25
7130	Hammer Pawl Pin	.25
7131	Hammer Pawl Spring	.25

† Grips sold only in matching pairs

Part Number	Part Name	Price
7534	Hammer Pivot Screw, Blue	.25
7434	Hammer Pivot Screw, Nickel	.25
7134	Hammer Safety Stop	.25
7182	Hammer Sleeve	.25
7335	Hammer Spring	.25
*7354	Hammer Spring Guide Head Assembly (includes Hammer Spring Guide Head 7336, Hammer Spring Guide Pin 7137)	1.65
7574	Hand	1.25
7181	Hand Spring	.25
7140	Link Pivot Pin	.25
10355	Medallion, Blue	.65
10356	Medallion, Nickel	.65
7577	Retaining Ring	.25
7578	Return Spring Washer	.25
7562	Sight, Front	1.10
7444	Sight, Rear	1.35
7382	Trigger	2.50
7384	Trigger and Trigger Spring Contact Pin 7130 Assembly	2.75
7339	Trigger Guard, Blue	5.00
7439	Trigger Guard, Nickel	5.50
7149	Trigger Pivot Pin	.25
7381	Trigger Spring	.25
7149	Trigger Spring Retaining Pin	.25
7540	Trigger Guard Assembly Pin, Blue	.25
7440	Trigger Guard Assembly Pin, Nickel	.25
7130	Trigger Spring Contact Pin	.25

INSTRUCTIONS FOR OPERATION AND CARE OF YOUR "DOUBLE-NINE" REVOLVER

LOADING AND FIRING:

1. Be sure that hammer is forward.
2. Hold Revolver in right hand with index finger of left hand against front of ejector latch housing. With left thumb move ejector latch to extreme forward position and, at the same time, swing out cylinder to left by pressing right index finger against it (See Figure 1). Be sure to release ejector latch.
3. Insert one .22 caliber short, long or long rifle cartridge in each of the nine chambers of the cylinder.
4. Return cylinder to frame by pressing thumb against cylinder. Do not push ejector latch forward when closing cylinder. The revolver is now ready to fire.
5. Revolver may be fired double action merely by squeezing trigger for each shot.
6. Target shooting, or other shooting demanding a maximum of accuracy, is usually done single action. For single-action shooting, pull back hammer to cocked position for each shot.
7. To unload revolver or remove fired cartridge cases, move ejector latch to extreme forward position and at the same time, swing out cylinder to left by pressing right index finger against it (See Figure 1), and push ejector rod to the rear (See Figure 2).
8. Spring loaded ejector will return automatically to forward position.
9. Because cylinder chambers are counterbored, revolver may be "dry-fired" without injury to cylinder.

Double-Nine revolvers are sighted in at a range of 50 feet. If lateral adjustment is desired because of individual preference in sighting or holding,

tap the rear sight gently, using a brass or plastic hammer. Move the rear sight in the direction you want the point of impact to move.



Fig. 1



Fig. 2

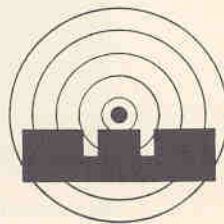

Correct Sighting

CARE AND CLEANING DOUBLE NINE

1. If, after extensive shooting, cleaning becomes necessary, the use of kerosene or any other good quality cleaning solution is recommended.

2. In cleaning the face of the cylinder or muzzle, an old toothbrush or similar brush should be used. Unless mud or foreign matter enters the bore, it

should be cleaned very sparingly. If cleaning becomes necessary, a stiff bristle brush or copper wire brush for .22 caliber guns should be used. After brushing, the bore should be swabbed with flannel patches attached to a .22 caliber cleaning rod (patches should be moistened with a good quality gun oil). The swabbing of the bore should be continued until the patches come out clean. IT IS STRONGLY EMPHASIZED THAT THE BORE RARELY REQUIRES CLEANING EXCEPT FOR THE PRESENCE OF MUD OR FOREIGN MATTER.

3. In cleaning the cylinders of the revolver, the same procedure as used in the cleaning of the bore should be employed.

4. The entire gun should be wiped dry of kerosene or cleaning solution with a clean absorbent cloth and then the surfaces should be wiped with a lightly oiled patch.

5. For best results in rust prevention only gun oils containing silicon should be used.

6. A few drops of light-bodied oil should be applied to the action internally near the pivot point of the hammer. Retract the hammer first — then work the trigger double action a few times to distribute the oil. The same procedure applies to the cylinder crane link and the ejector latch slot in the housing affixed to the barrel.

7. Avoid using heavy-bodied oils. No animal or vegetable oils should ever be used in guns.

8. If the gun is used in climates where extreme cold prevails, powdered graphite should be substituted for oil in lubricating the internal mechanism. In moist climates the gun should be cleaned more frequently and preferably stored in a container treated with silicones to prevent rust.

Hi-Standard .22 Caliber Autoloading Pistols

ALL-STEEL FIELD MODELS



Sport-King: Favorite .22 long rifle autoloader boasts remarkable engineering advances and wonder metals for top performance in the field. Ideal handgun for hunters, trappers, campers, fishermen, plinkers, target shooters.

Flite-King: Same outstanding features as Sport-King, but fires thrifty, quiet .22 shorts.



Dura-Matic: The perfect extra gun at a low price. Fires .22 long rifle ammunition with excellent accuracy. Double safety has a visible indicator to show when gun is ready to fire, plus a combination slide lock for positive cross-bolt safety. This versatile 10-shot autoloader fits the need of many shooters who can take pride in its sleek, modern lines.

LIGHTWEIGHT FIELD MODEL



Sport-King Lightweight: High tensile metals used in missiles are crafted into forged-alloy frames for these amazing handguns. Light in weight for easy carrying, you get tremendous durability for a lifetime of shooting fun. Sport-King Lightweight is a ten-shot .22 long rifle autoloader available in blued finish.

SUPER-ACCURATE TARGET MODELS



Supermatic Trophy: A possession of pride worthy of the world's greatest champions. Superb hand-finishing inside and out for unexcelled beauty and precision performance. Ten-shot .22 L.R. autoloader has gold trigger and lettering, walnut grips.

Supermatic Citation: All the features of Trophy with Citation-grade finish, laminated grips.

Olympic: .22 short version of this superb target-grade handgun.



Supermatic Tournament: Top value in a medium-priced target pistol. Full measure of Hi-Standard quality with all but a few of the custom extras found in the Trophy. Choice of 4½" or 6¾" heavy, tapered, interchangeable barrels. Double-action safety. Sure-fire magazine. Diamond-checked laminated grips.